

FORMPAK INC

SCREW FEEDER IOM 2021 EDITION

DISCLAIMERS:

NOT ALL ITEMS IN THIS MANUAL ARE ON EVERY SYSTEM.

SYSTEM CONFIGURATIONS VARY PER CUSTOMER ORDERS & SPECS.

ANY MODIFICATIONS TO THE EQUIPMENT WITHOUT APPROVAL OF FORMPAK ENGINEERING WILL
RESULT IN VOIDING ANY WARRANTY.

Operation Hours

Monday – Friday 8:00AM – 5:00PM CST

Contacts at FormPak

Mike Owens Ext 402

Sales / General Questions
Email: mike@formpakinc.com

Larry Markos, P.E. Ext 403

Engineering / Technical Support / Maintenance
Email: larry@formpakinc.com

Robert Contreras Ext 405

Operations Manager Email:
Email: robert@formpakinc.com

Joseph Beckerman Ext 414

Electrical / Controls Email:
Email: josephb@formpakinc.com

Ken Poorman Ext 412

Purchasing / Parts Email:
Email: kenp@formpakinc.com

Fax : 314-475-3201

Approved By: Lucas Pulley	Approved By: Amanda Michaels	Document Name: 111-CM-SF	Rev: 0.0
-------------------------------------	--	------------------------------------	--------------------

Screw Feeder

FormPak's Screw Feeder is designed to meter feed material that has been discharged from a bulk bag, so it can be conveyed or integrated into a process. It is a simple design, requiring minimal maintenance, yet very effective. The tube comes in usual sizes of 4" or 3" OD, but can become more custom. The auger itself has a standard, however like most FormPak machinery, it can vary per the customer material and/or needs of the unit design.

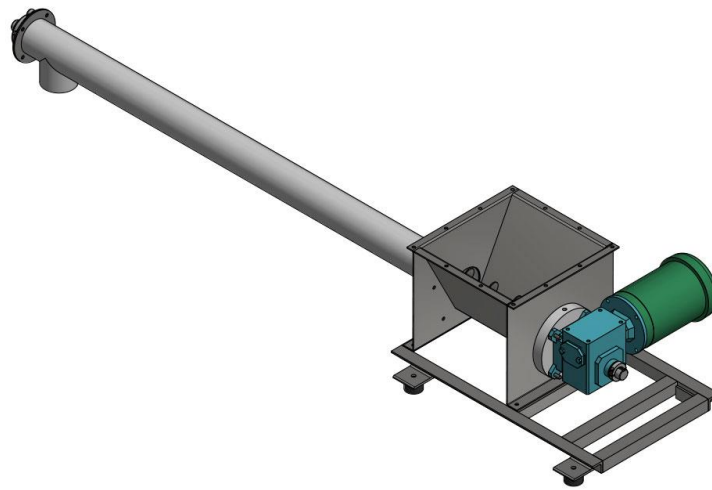

Gearbox lubrication is for life, as long as there are no leaks. Leaks should be addressed as soon as possible. A leaking seal is often a sign of a failed bearing.

Motor rotation direction is not important, but motor **voltage** is. Be sure the electrician wires the motor for the correct three phase voltage.

Maintenance daily inspections should be done over all bolts & nuts to verify all are tight and secure. The Auger and Tube should also be inspected to look for wear and tear. Most commonly this will be seen on the ends of the tube and auger due to the rotation of the machine. Lastly, welds on the exterior and interior are to be looked over for visible cracks and/or defects. This is not common, but over time this can occur depending on material, amount of usage, and improper maintenance over the auger